

# QUICK START GUIDE

TUNE220TWS



## WHAT'S IN THE BOX

Obsah krabice

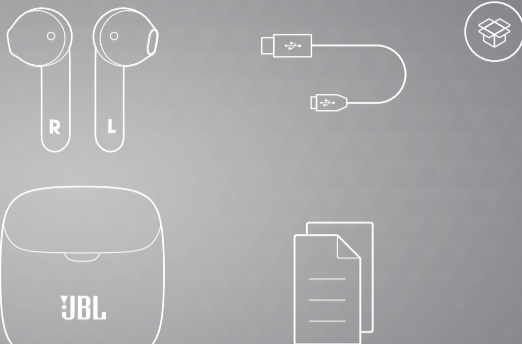

## HOW TO WEAR

Jak nosit

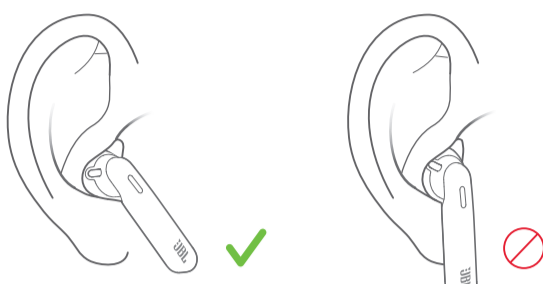

## FIRST TIME USE

První použití

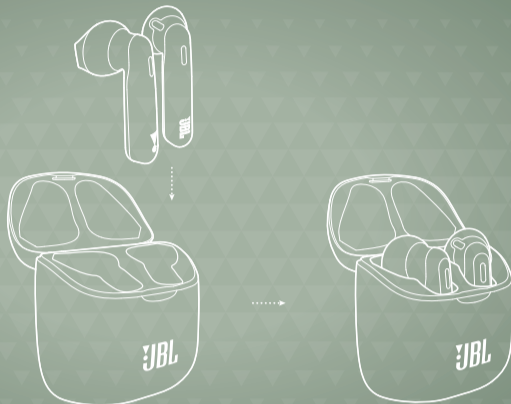

## POWER ON & CONNECT

Zapnutí a párování

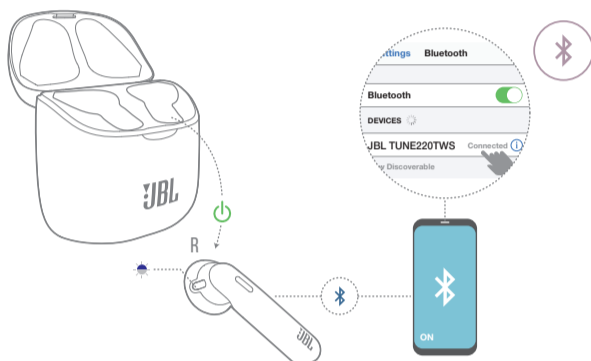

Automatický vstup do párovacího režimu Vyberte "JBL TUNE220TWS"

## PAIRING

Párování

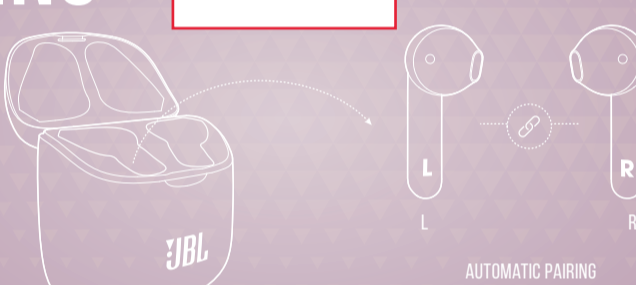

Automatické párování

## POWER OFF

Vypnutí

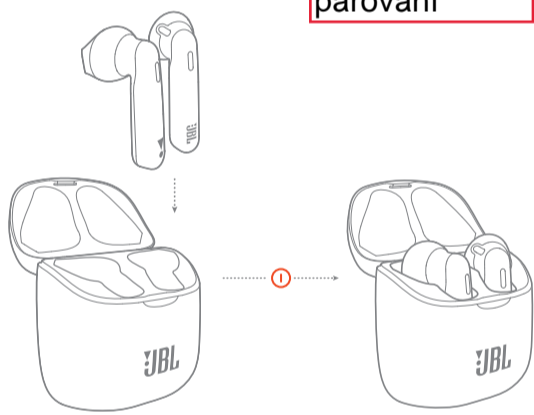

## MANUAL CONTROLS

Manuál ovládání

Zapněte a připojte se k zařízení	Znovupropojení pravého a levého	Zapnout	Vypnout
<p>POWER ON &amp; CONNECT TO DEVICE</p>	<p>RECONNECTING LEFT &amp; RIGHT</p>	<p>POWER ON</p>	<p>POWER OFF</p>

## BUTTON COMMAND

Příkazové tlačítko



## CHARGING

Nabíjení

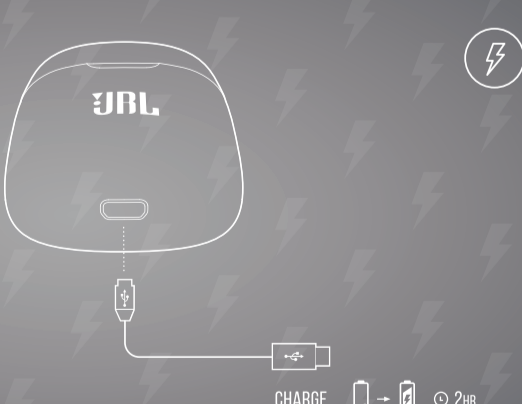

## LED BEHAVIORS

LED indikátor

LED Behavior	Meaning
Low battery icon	LOW BATTERY
Charging icon	CHARGING
Fully charged icon	FULLY CHARGED

LED Behavior	Meaning
Light on, BT icon	POWER ON
Flashing light, BT icon	BT CONNECTING
Steady light, BT icon	BT CONNECTED
Light on, battery icon	LOW BATTERY
Light on, battery icon	CHARGING
Light on, battery icon	FULLY CHARGED

Nízký stav baterie nabíjení plně nabit

Zapnuto  
BT připojování  
BT připojen  
Nízký stav baterie  
nabíjení

## TECH SPEC

Driver Size:	12 mm Dynamic driver
Frequency Response:	20 Hz – 20 kHz
Sensitivity:	105 dB SPL
Maximum SPL:	98 dB SPL
Microphone sensitivity:	-30 dBV@1 kHz/Pa
Impedance:	32 ohm
Bluetooth transmitted power:	12 dBm
Bluetooth profile version:	GFSK/ n/4DQPSK/ 8DPSK
Bluetooth frequency:	2.402 GHz – 2.48 GHz
Bluetooth version:	A2DP 1.3, AVRCP 1.5, HFP 1.6
Headset battery type:	5.0
Charging case battery type:	Lithium-ion battery (22 mAh / 3.85 V)
Power supply:	Lithium-ion battery (410 mAh / 3.85 V)
Charging time:	5V === 1.0 A
Music playtime with BT on:	<2 hrs from empty
Total music playtime with charging case:	3 hrs
Weight:	19 hrs
	57 g

